

S.I. Storey
LUMBER COMPANY, INC.
Since 1920



StreetGuard™

Designed to meet the special needs of Developers and land planners, StreetGuard™ is the safety barrier solution that enhances the landscape. Intended for use along low speed roadways in parks, private developments and subdivisions, StreetGuard™ is the aesthetic alternative to traditional galvanized steel W-beam guardrail.



Osmose® Wood Products
Licensed Manufacturer
Since 1955

285 Sike Storey Rd. • P.O. Box 99
Armuchee, GA 30105
Phone: 888-934-1605 Fax: 706-235-8132

Southern Pine Inspection
Bureau Member
Since 1943

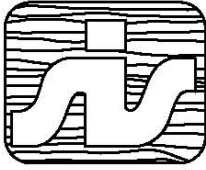

S.I. Storey
LUMBER COMPANY, INC.

S.I. STOREY LUMBER CO., INC.
285 SIKE STOREY RD NW
P.O. BOX 99
ARMUCHEE, GA 30105-0099
TOLL FREE: (888) 934-1605
PHONE: (706) 234-1605
FAX: (706) 235-8132
www.timbarrier.com

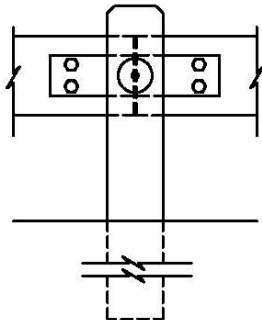
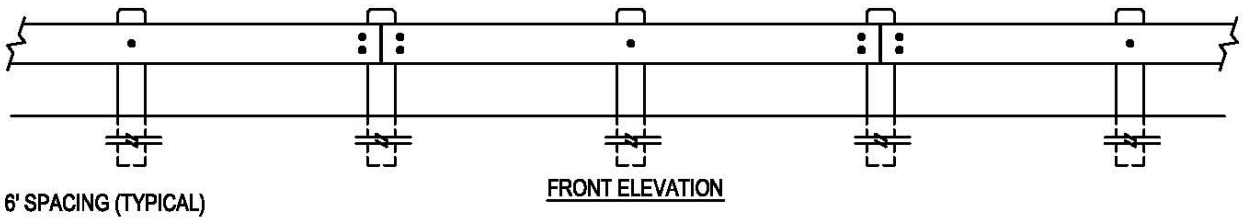
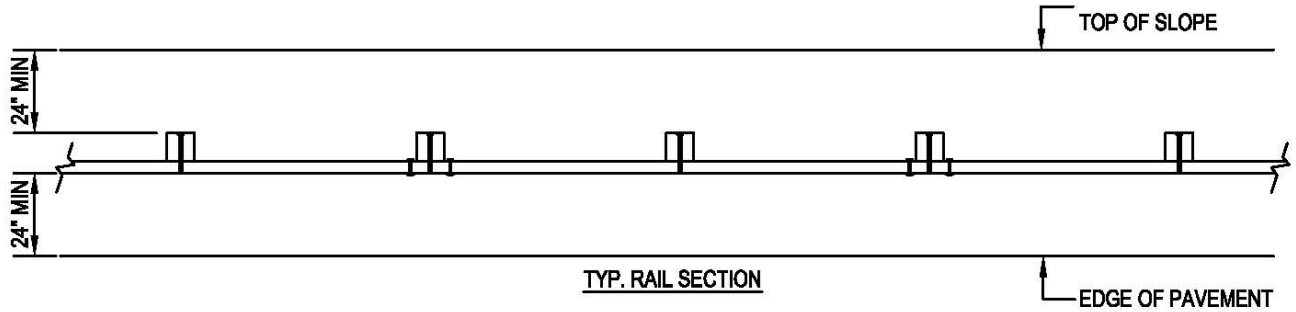

POST CONNECTION
NOT TO SCALE

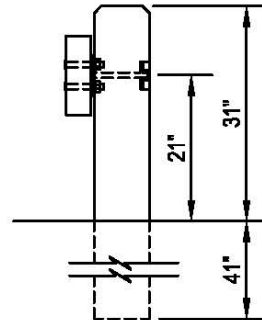

TYP. GUARDRAIL CROSS SECTION
1:10 SLOPE OR FLATTER
NOT TO SCALE

NOTES:

1. INSTALLATION TO BE COMPLETED IN ACCORDANCE WITH MANUFACTURER'S SPECIFICATIONS.
2. DO NOT SCALE DRAWINGS.
3. IF TOP OF SLOPE IS CLOSER THAN 24" INCREASE POST LENGTH TO 7'.
4. DRIVE POSTS OR AUGER, BACKFILL WITH NATIVE SOIL AND COMPACT EVERY 12".
5. ALL TIMBER #1 S4S SOUTHERN PINE, PRESSURE TREATED: AWPAC14, WOOD FOR USE IN HWY. CONSTR.
6. TYP. POST: 8" X 8" X 6' - TYP. RAIL: 4" X 12" X 11' 11 1/2"
7. FASTENERS: ASTM A307; A242; F436 TYPE 3; A563 DH3.
8. TIMBARRIER™ SPLICE PLATE & PLATE WASHER ASTM-A588.
9. UNDER EACH BOLT HEAD ON FACE OF RAIL INSTALL ONE 7/8" WASHER.
10. REFER TO DRAWINGS 651-003b OR 651-003c FOR TERMINAL DETAILS
11. CONTRACTORS NOTE: FOR PRODUCT AND COMPANY INFORMATION VISIT www.CADdetails.com/info REFERENCE NUMBER 651-003.

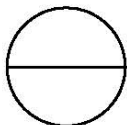

TIMBARRIER™

STREETGUARD™ ROADWAY AND STREET APPLICATIONS (25 MPH MAX.)